

Tritax Symmetry (Hinckley) Limited

HINCKLEY NATIONAL RAIL FREIGHT INTERCHANGE

The Hinckley National Rail Freight Interchange Development Consent Order

Project reference TR050007

HNRFI HGV Route Management Plan and Strategy (Appendices)

Report Prepared by: BWB Consulting Ltd.

Document reference: 17.4DE

Revision: ~~13~~14

~~20-27~~ February 2024

Planning Act 2008

The Infrastructure Planning (Applications: Prescribed Forms and Procedure) Regulations 2009
Regulation 5(2)(q)

The Infrastructure Planning (Environmental Impact Assessment) Regulations 2017
Regulation 14

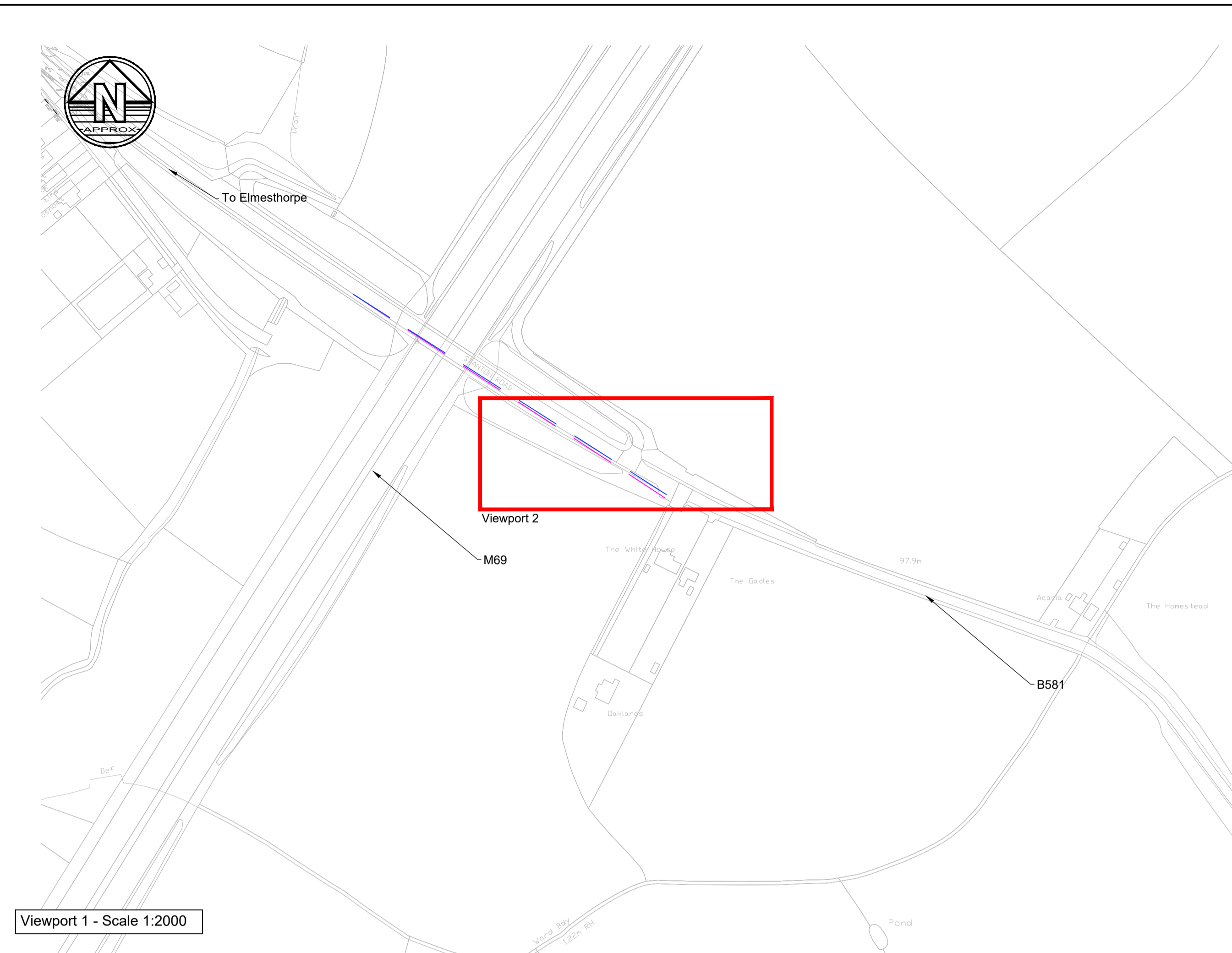

Viewport 1 - Scale 1:2000



Streetview Image of Approximate Location



Viewport 2 - Scale 1:200

- Notes**
1. Do not scale this drawing. All dimensions must be checked/ verified on site. If in doubt ask.
 2. This drawing is to be read in conjunction with all relevant architects, engineers and specialists drawings and specifications.
 3. All dimensions in millimetres unless noted otherwise. All levels in metres unless noted otherwise.
 4. Any discrepancies noted on site are to be reported to the engineer immediately.
 5. ANPR locations shown indicatively. Subject to detailed design, survey and approval by relevant highway authorities.

Legend

- LCC Highway Boundary

P03	27.02.24	Visibility Splays Added	SC	SD
P02	20.02.24	Drawing Number Update	SC	AP
P01	31.01.24	Preliminary Issue	SC	AP
Rev	Date	Details of issue / revision	Drw	Rev

Issues & Revisions

BWB
A CAF GROUP COMPANY

- Birmingham | 0121 233 3322
- Leeds | 0113 233 8000
- London | 020 7407 3879
- Manchester | 0161 233 4260
- Nottingham | 0115 924 1100

www.bwbconsulting.com

Client

TRITAX SYMMETRY
A TRITAX BIG BOX COMPANY

Project Title

**HINCKLEY NATIONAL RAIL
FREIGHT INTERCHANGE**

Drawing Title

**HGV ROUTING
STRATEGY
ANPR CAMERA 1
LOCATION**

Drawn:	S. Carter	Reviewed:	A. Passmore
BWB Ref:	NTT2814	Date:	20.02.24
Scale@A1:	As Shown	Status:	S2
Drawing Status	PRELIMINARY		
Project - Originator - Zone - Level - Type - Role - Number	Status	Rev	
HRF-BWB-HSN-01-DR-CH-1250	S2	P03	

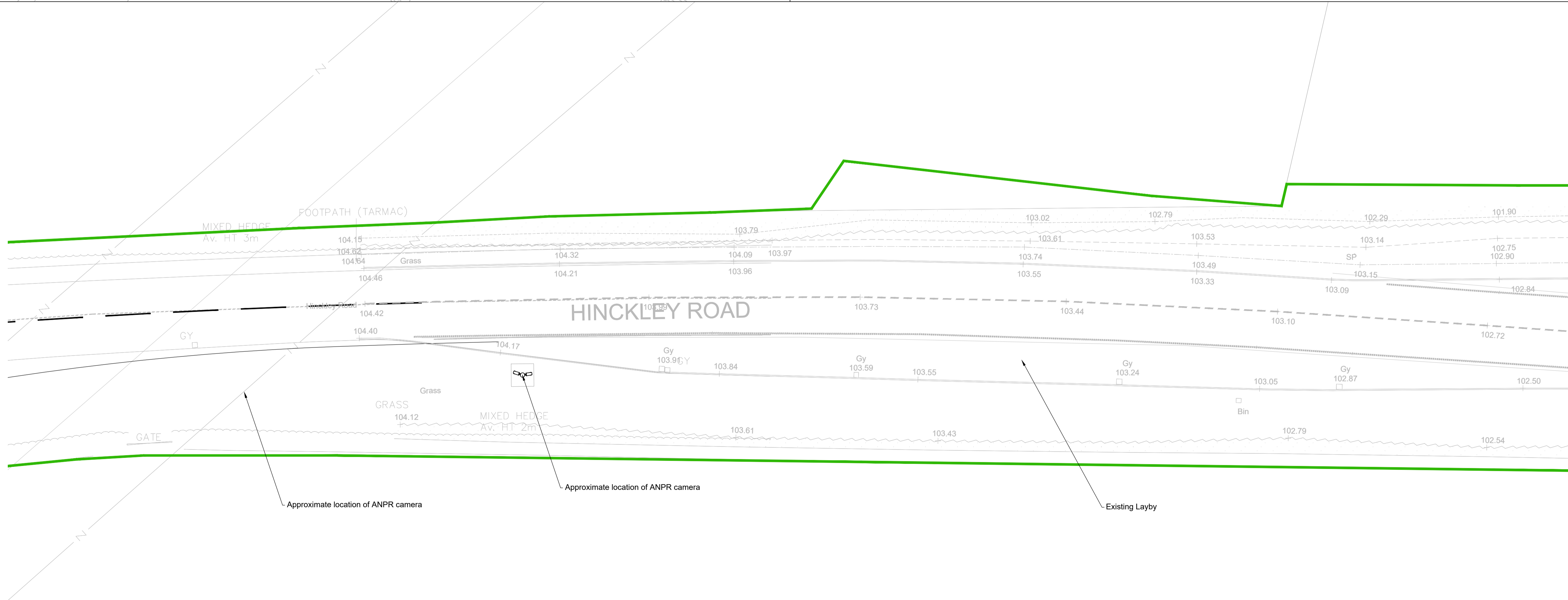
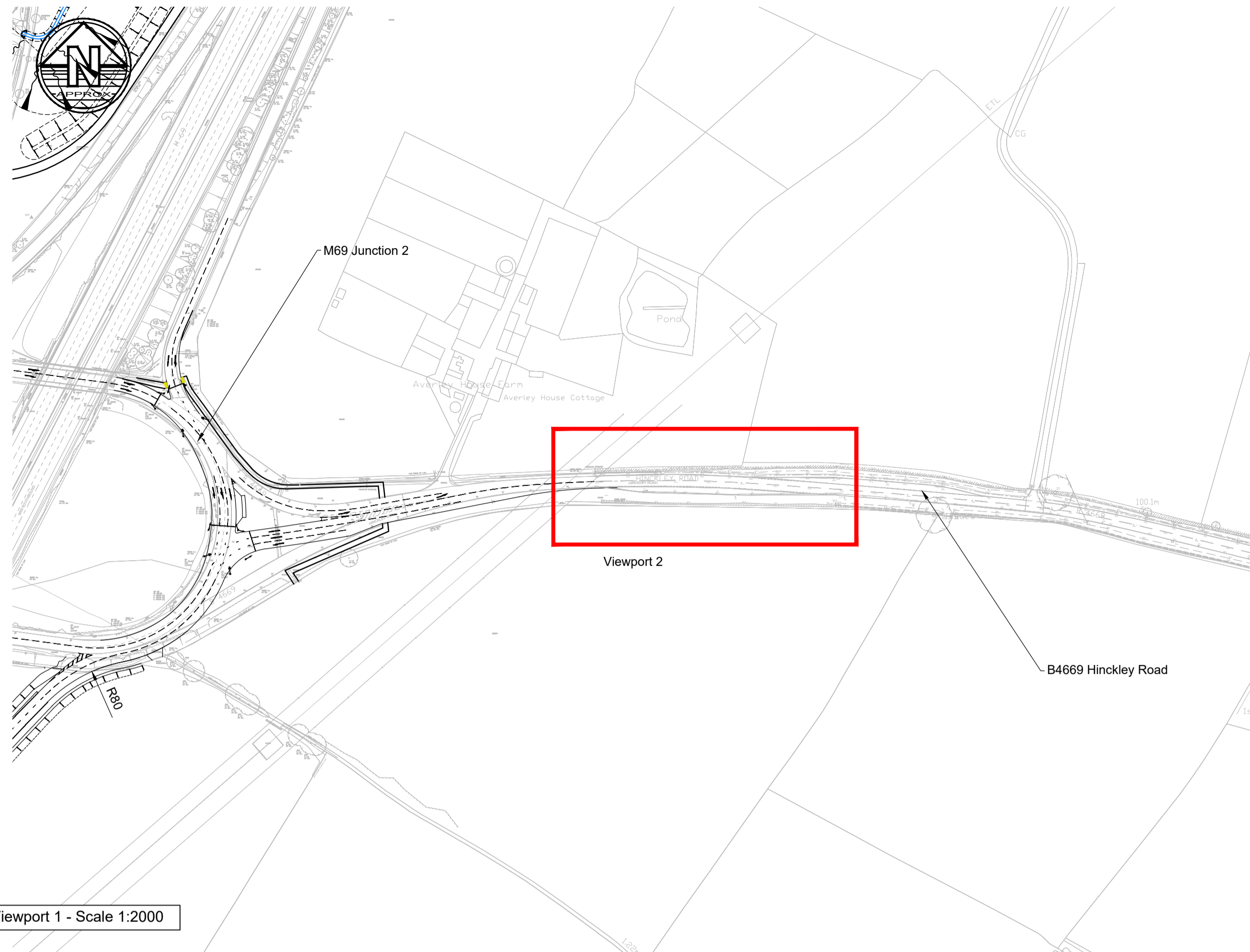

P02	20.02.24	Drawing number Update	SC	AP
P01	31.01.24	Preliminary Issue	SC	AP
Rev	Date	Details of issue / revision	Drw	Rev

Issues & Revisions

BWB
A CAF GROUP COMPANY

- Leeds | 0115 233 8000
- London | 020 7407 3879
- Manchester | 0161 233 4260
- Nottingham | 0115 924 1100

www.bwbconsulting.com

Client

TRITAX SYMMETRY
A TRITAX BIG BOX COMPANY

Project Title

HINCKLEY NATIONAL RAIL FREIGHT INTERCHANGE

Drawing Title

HGV ROUTING STRATEGY ANPR CAMERA 2 LOCATION

Drawn:	S. Carter	Reviewed:	A. Passmore
BWB Ref:	NTT2814	Date:	20.02.24
Scale@A1:	As Shown		

Drawing Status

PRELIMINARY

Project - Originator - Zone - Level - Type - Role - Number	Status	Rev
HRF-BWB-HSN-02-DR-CH-1250	S2	P02

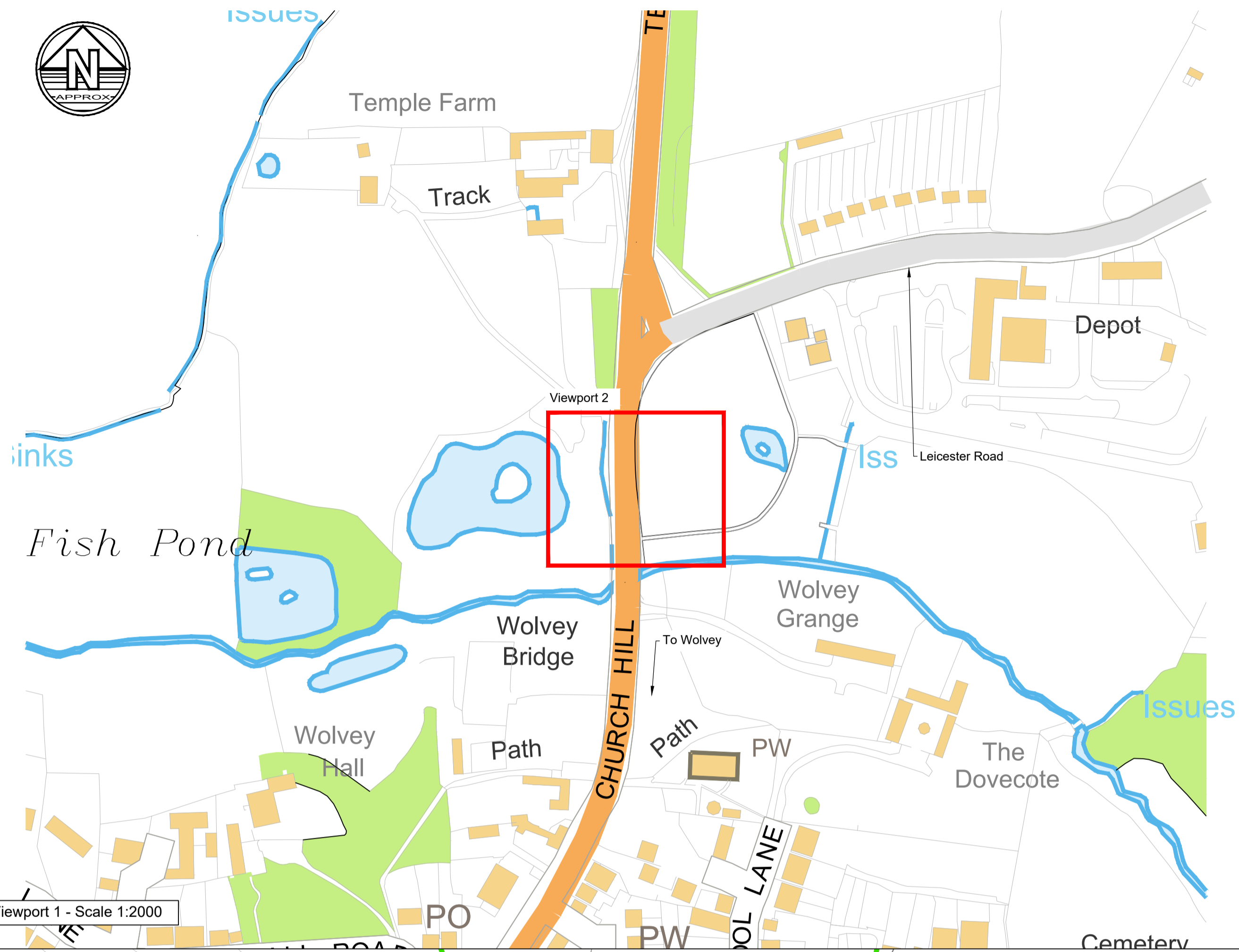

Streetview Image of Approximate Location



Notes

1. Do not scale this drawing. All dimensions must be checked/ verified on site. If in doubt ask.
2. This drawing is to be read in conjunction with all relevant architects, engineers and specialists drawings and specifications.
3. All dimensions in millimetres unless noted otherwise. All levels in metres unless noted otherwise.
4. Any discrepancies noted on site are to be reported to the engineer immediately.
5. ANPR locations shown indicatively. Subject to detailed design, survey and approval by relevant highway authorities.

Legend

Indicative WCC Highway Boundary

P02	20.02.24	Relocated Camera	SC	AP
P01	31.01.24	Preliminary Issue	SC	AP
Rev	Date	Details of issue / revision	Drw	Rev

Issues & Revisions

BWB
A CAF GROUP COMPANY

- Birmingham | 0121 233 3322
- Leeds | 0113 233 8000
- London | 020 7407 3879
- Manchester | 0161 233 4260
- Nottingham | 0115 924 1100

www.bwbconsulting.com

TRITAX SYMMETRY
A TRITAX BIG BOX COMPANY

**HINCKLEY NATIONAL RAIL
FREIGHT INTERCHANGE**

**HGV ROUTING
STRATEGY
ANPR CAMERA 3
LOCATION**

Drawn:	S. Carter	Reviewed:	A. Passmore
--------	-----------	-----------	-------------

BWB Ref:	NTT2814	Date:	20.02.24	Scale@A1:	As Shown
----------	---------	-------	----------	-----------	----------

PRELIMINARY

Project - Originator - Zone - Level - Type - Role - Number	Status	Rev
HRF-BWB-HSN-03-DR-CH-1250	S2	P02

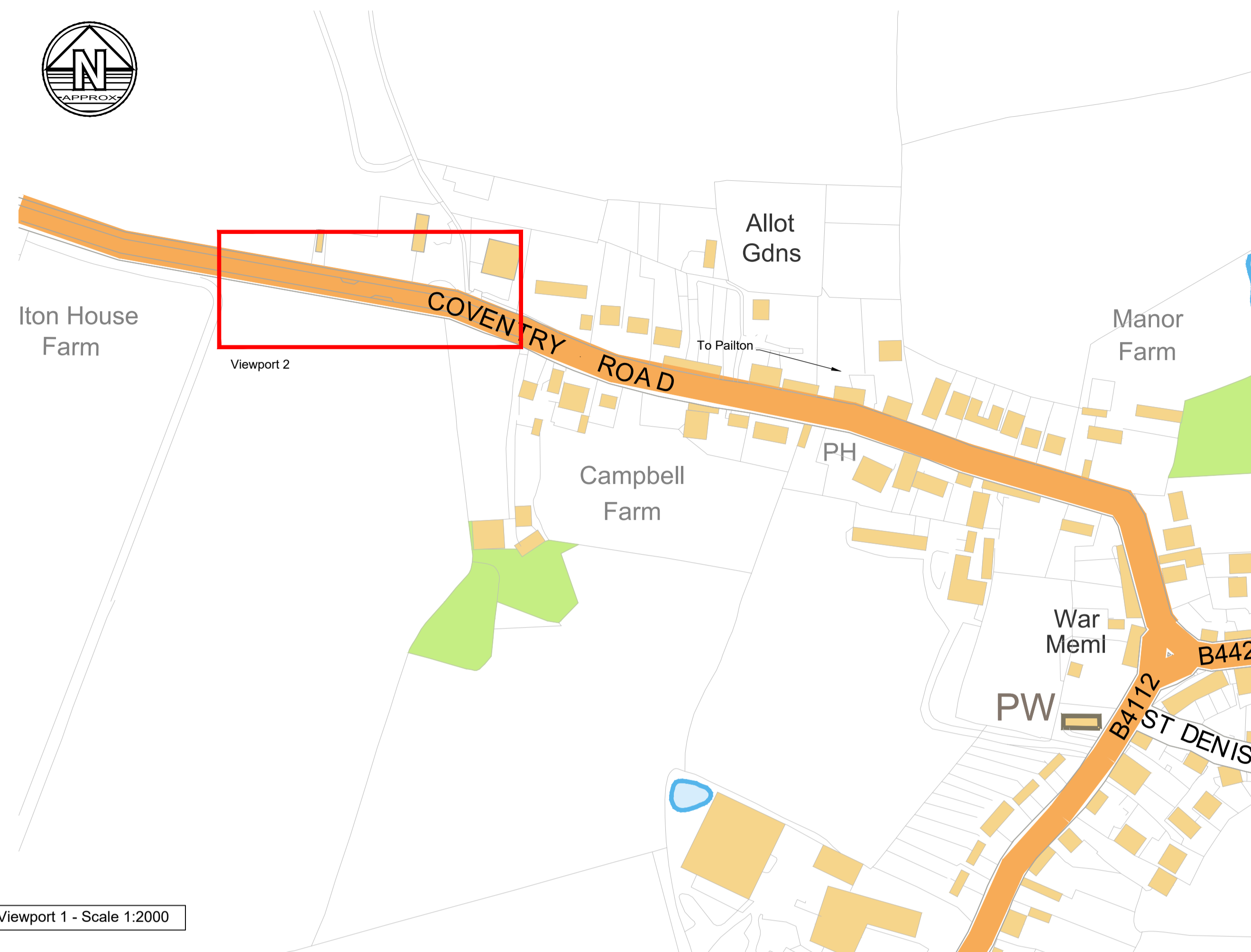

Viewport 1 - Scale 1:2000



Streetview Image of Approximate Location



Viewport 2 - Scale 1:200

Notes

1. Do not scale this drawing. All dimensions must be checked/ verified on site. If in doubt ask.
2. This drawing is to be read in conjunction with all relevant architects, engineers and specialists drawings and specifications.
3. All dimensions in millimetres unless noted otherwise. All levels in metres unless noted otherwise.
4. Any discrepancies noted on site are to be reported to the engineer immediately.
5. ANPR locations shown indicatively. Subject to detailed design, survey and approval by relevant highway authorities.

Legend

Indicative WCC Highway Boundary

P01	31.01.24	Preliminary Issue	SC	AP
Rev	Date	Details of issue / revision	Drw	Rev

Issues & Revisions

BWB
A CAF GROUP COMPANY

- Birmingham | 0121 233 3322
- Leeds | 0113 233 8000
- London | 020 7407 3879
- Manchester | 0161 233 4260
- Nottingham | 0115 924 1100

www.bwbconsulting.com

Client

TRITAX SYMMETRY
A TRITAX BIG BOX COMPANY

HINCKLEY NATIONAL RAIL FREIGHT INTERCHANGE

HGV ROUTEING STRATEGY ANPR CAMERA 4 LOCATION

Drawn:	S. Carter	Reviewed:	A. Passmore
BWB Ref:	NTT2814	Date:	31.01.24
Scale@A1:	As Shown		

PRELIMINARY

Project - Originator - Zone - Level - Type - Role - Number	Status	Rev
HRF-BWB-HSN-04-DR-CH-1250	S2	P01

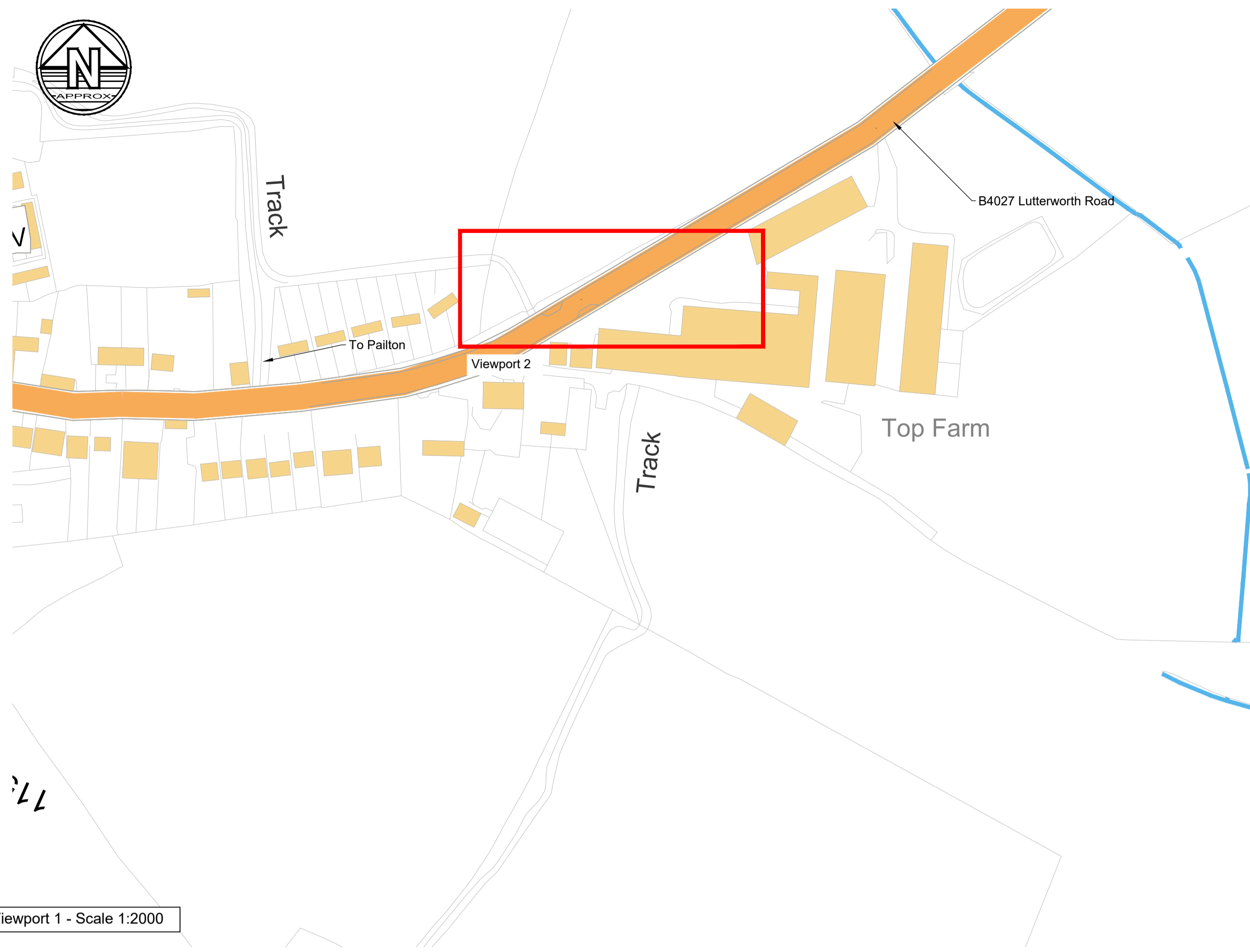

Viewport 1 - Scale 1:2000



Streetview Image of Approximate Location



Viewport 2 - Scale 1:200

Notes

1. Do not scale this drawing. All dimensions must be checked/ verified on site. If in doubt ask.
2. This drawing is to be read in conjunction with all relevant architects, engineers and specialists drawings and specifications.
3. All dimensions in millimetres unless noted otherwise. All levels in metres unless noted otherwise.
4. Any discrepancies noted on site are to be reported to the engineer immediately.
5. ANPR locations shown indicatively. Subject to detailed design, survey and approval by relevant highway authorities.

Legend

Indicative WCC Highway Boundary

P01	31.01.24	Preliminary Issue	SC	AP
Rev	Date	Details of issue / revision	Drw	Rev

Issues & Revisions

BWB
A CAF GROUP COMPANY

- Birmingham | 0121 233 3322
- Leeds | 0113 233 8000
- London | 020 7407 3879
- Manchester | 0161 233 4260
- Nottingham | 0115 924 1100

www.bwbconsulting.com

Client

TRITAX SYMMETRY
A TRITAX BIG BOX COMPANY

Project Title

**HINCKLEY NATIONAL RAIL
FREIGHT INTERCHANGE**

Drawing Title

**HGV ROUTING
STRATEGY
ANPR CAMERA 5
LOCATION**

Drawn:	S. Carter	Reviewed:	A. Passmore
BWB Ref:	NTT2814	Date:	31.01.24
Scale@A1:	As Shown		

Drawing Status

PRELIMINARY

Project - Originator - Zone - Level - Type - Role - Number	Status	Rev
HRF-BWB-HSN-05-DR-CH-1250	S2	P01

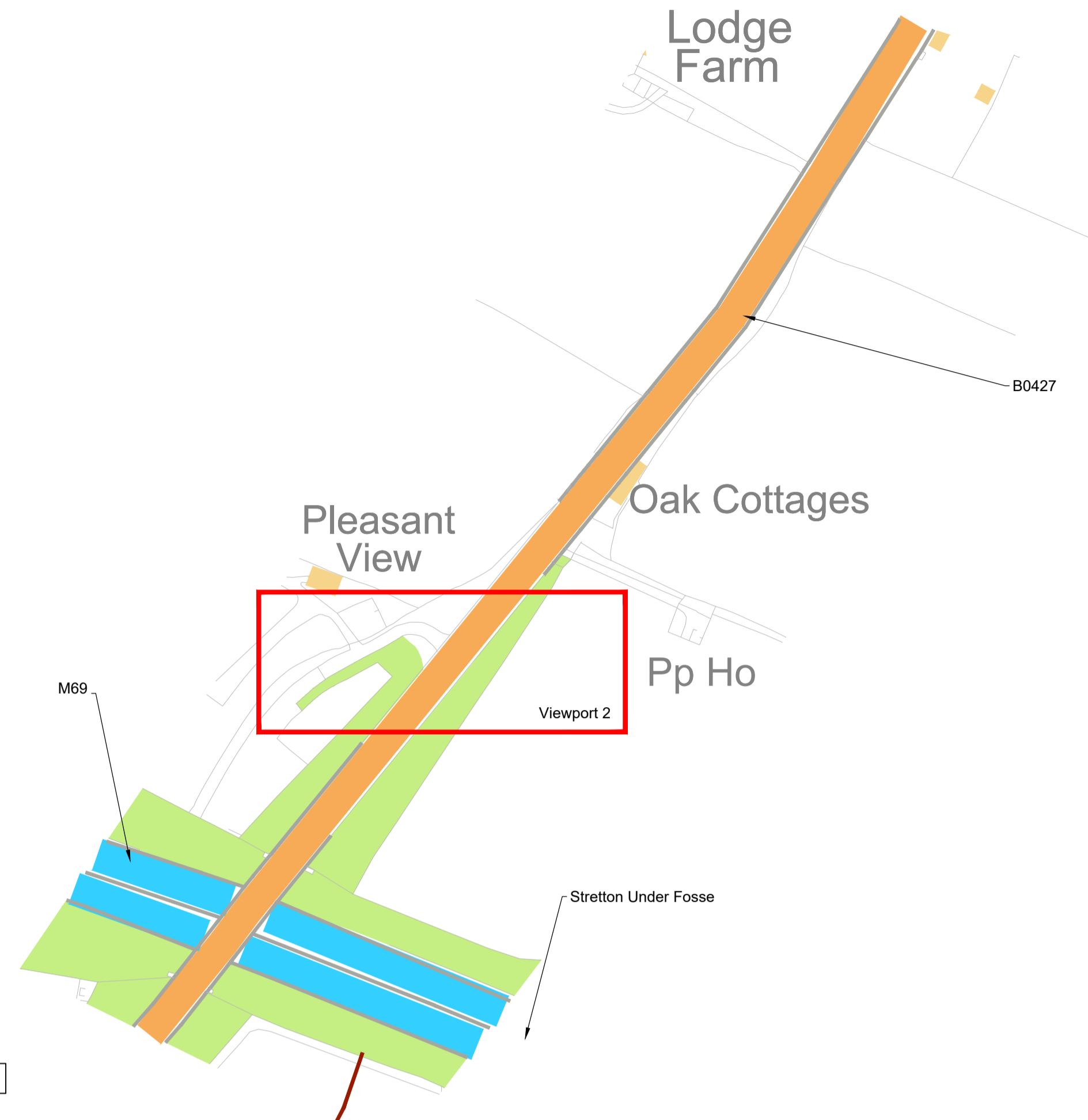

Viewport 1 - Scale 1:2000



Streetview Image of Approximate Location



Viewport 2 - Scale 1:200

Notes

1. Do not scale this drawing. All dimensions must be checked/ verified on site. If in doubt ask.
2. This drawing is to be read in conjunction with all relevant architects, engineers and specialists drawings and specifications.
3. All dimensions in millimetres unless noted otherwise. All levels in metres unless noted otherwise.
4. Any discrepancies noted on site are to be reported to the engineer immediately.
5. ANPR locations shown indicatively. Subject to detailed design, survey and approval by relevant highway authorities.

Legend

Indicative WCC Highway Boundary

P02	20.02.24	Relocated Camera	SC	AP
P01	31.01.24	Preliminary Issue	SC	AP
Rev	Date	Details of issue / revision	Drw	Rev

Issues & Revisions

BWB
A CAF GROUP COMPANY

- Birmingham | 0121 233 3322
- Leeds | 0113 233 8000
- London | 020 7407 3879
- Manchester | 0161 233 4260
- Nottingham | 0115 924 1100

www.bwbconsulting.com

Client

TRITAX SYMMETRY
A TRITAX BIG BOX COMPANY

Project Title

HINCKLEY NATIONAL RAIL FREIGHT INTERCHANGE

Drawing Title

HGV ROUTING STRATEGY ANPR CAMERA 6 LOCATION

Drawn:	S. Carter	Reviewed:	A. Passmore
BWB Ref:	NTT2814	Date:	20.02.24
Scale@A1:	As Shown	Status:	Rev

Drawing Status

PRELIMINARY

Project - Originator - Zone - Level - Type - Role - Number	Status	Rev
HRF-BWB-HSN-06-DR-CH-1250	S2	P02



The Old Vicarage

Fox Close

MAIN ST

The Hayes

SMYTHE CL

Monks Kirby

BELL LANE

PPp Hto

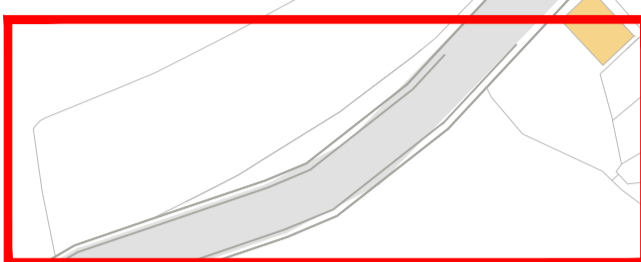

Viewport 2

B4027

Viewport 1 - Scale 1:2000



Streetview Image of Approximate Location

Approximate location of ANPR camera



B4027

Viewport 2 - Scale 1:200

Notes

1. Do not scale this drawing. All dimensions must be checked/ verified on site. If in doubt ask.
2. This drawing is to be read in conjunction with all relevant architects, engineers and specialists drawings and specifications.
3. All dimensions in millimetres unless noted otherwise. All levels in metres unless noted otherwise.
4. Any discrepancies noted on site are to be reported to the engineer immediately.
5. ANPR locations shown indicatively. Subject to detailed design, survey and approval by relevant highway authorities.

Legend

Indicative WCC Highway Boundary

P01	31.01.24	Preliminary Issue	SC	AP
Rev	Date	Details of issue / revision	Drw	Rev

Issues & Revisions

BWB
A CAF GROUP COMPANY

- Birmingham | 0121 233 3322
- Leeds | 0113 233 8000
- London | 020 7407 3879
- Manchester | 0161 233 4260
- Nottingham | 0115 924 1100

www.bwbconsulting.com

Client

TRITAX SYMMETRY
A TRITAX BIG BOX COMPANY

HINCKLEY NATIONAL RAIL FREIGHT INTERCHANGE

HGV ROUTEING STRATEGY ANPR CAMERA 7 LOCATION

Drawn:	S. Carter	Reviewed:	A. Passmore
--------	-----------	-----------	-------------

BWB Ref:	NTT2814	Date:	31.01.24	Scale@A1:	As Shown
----------	---------	-------	----------	-----------	----------

PRELIMINARY

Project - Originator - Zone - Level - Type - Role - Number	Status	Rev
HRF-BWB-HSN-07-DR-CH-1250	S2	P01

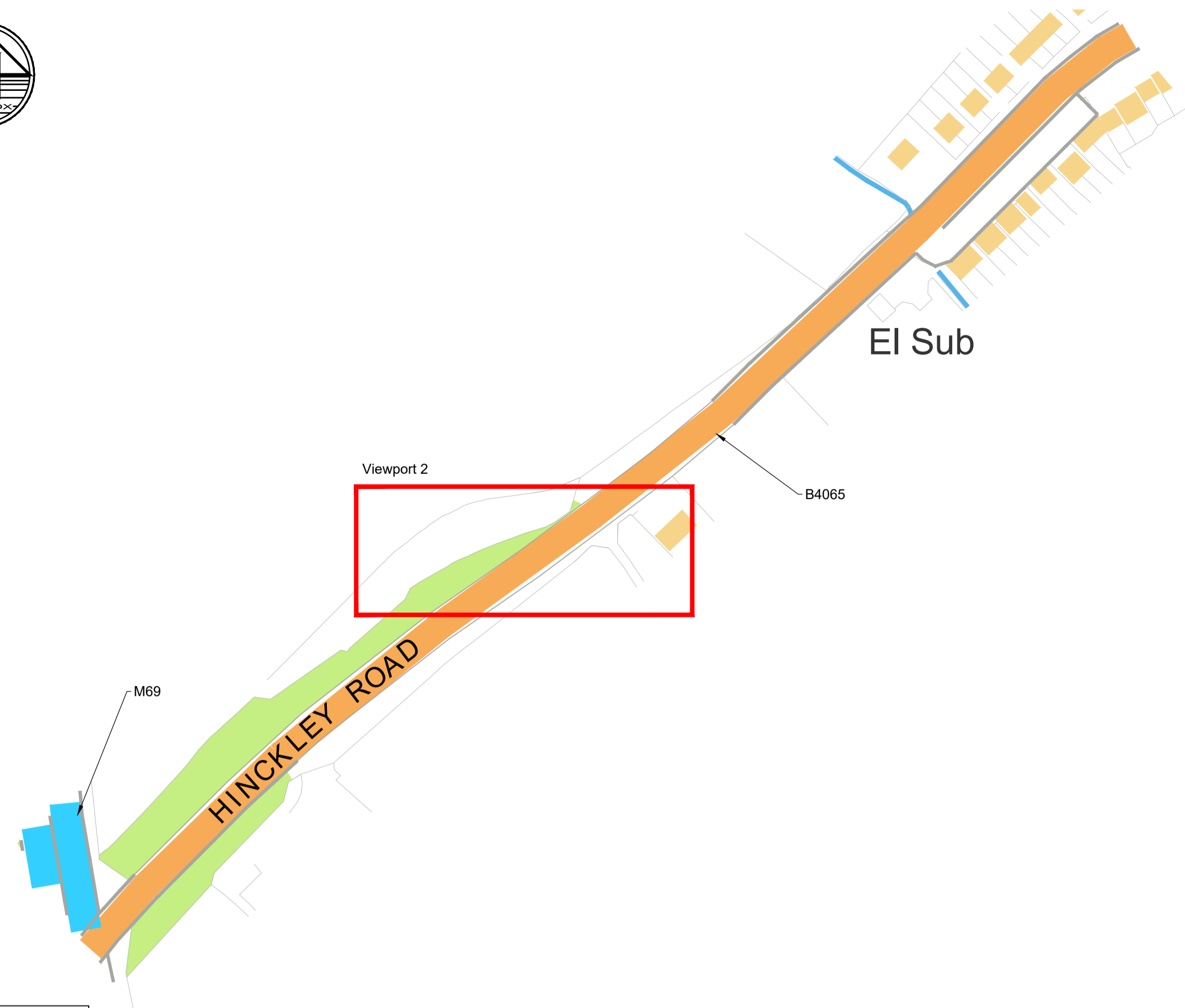

Viewport 1 - Scale 1:2000



Streetview Image of Approximate Location



Viewport 2 - Scale 1:200

Notes

1. Do not scale this drawing. All dimensions must be checked/ verified on site. If in doubt ask.
2. This drawing is to be read in conjunction with all relevant architects, engineers and specialists drawings and specifications.
3. All dimensions in millimetres unless noted otherwise. All levels in metres unless noted otherwise.
4. Any discrepancies noted on site are to be reported to the engineer immediately.
5. ANPR locations shown indicatively. Subject to detailed design, survey and approval by relevant highway authorities.

Legend

— Indicative WCC Highway Boundary

P01	20.02.24	Preliminary Issue	SC	AP
Rev	Date	Details of issue / revision	Drw	Rev

Issues & Revisions

BWB
A CAF GROUP COMPANY

- Birmingham | 0121 233 3322
- Leeds | 0113 233 8000
- London | 020 7407 3879
- Manchester | 0161 233 4260
- Nottingham | 0115 924 1100

www.bwbconsulting.com

Client

TRITAX SYMMETRY
A TRITAX BIG BOX COMPANY

HINCKLEY NATIONAL RAIL FREIGHT INTERCHANGE

HGV ROUTING STRATEGY ANPR CAMERA 8 LOCATION

Drawn:	S. Carter	Reviewed:	A. Passmore
BWB Ref:	NTT2814	Date:	20.02.24
Scale@A1:	As Shown	Status:	PRELIMINARY

Project - Originator - Zone - Level - Type - Role - Number	Status	Rev
HRF-BWB-HSN-08-DR-CH-1250	S2	P01

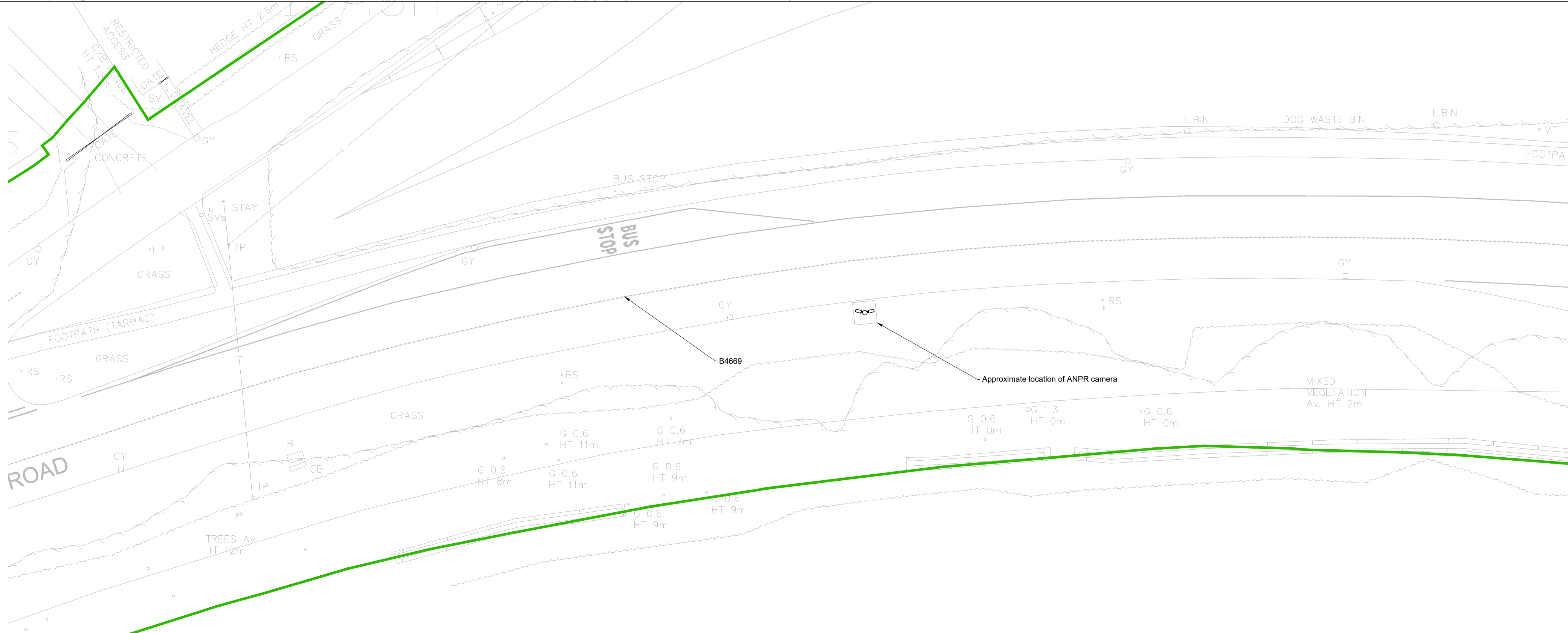
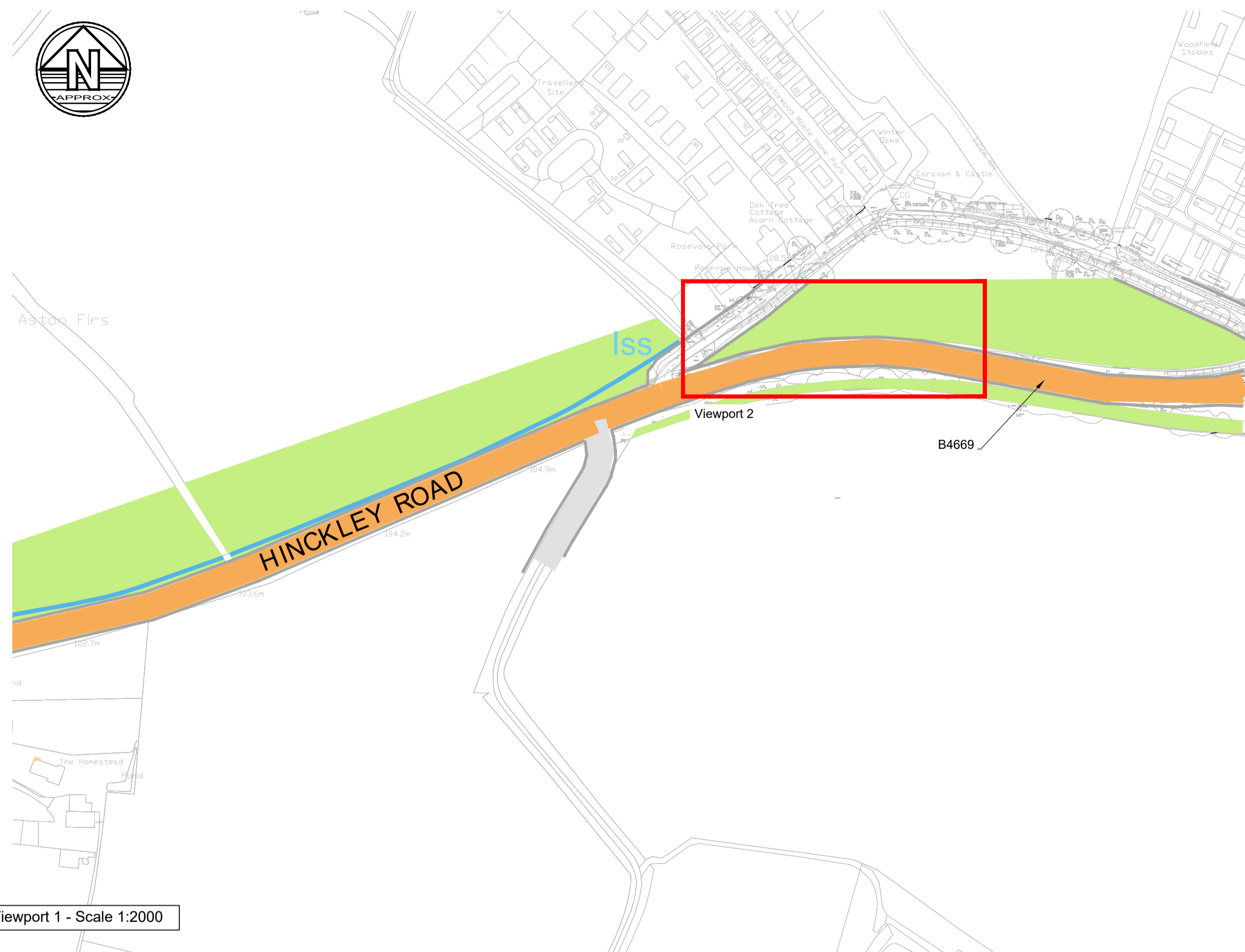

- Notes**
1. Do not scale this drawing. All dimensions must be checked/ verified on site. If in doubt ask.
 2. This drawing is to be read in conjunction with all relevant architects, engineers and specialists drawings and specifications.
 3. All dimensions in millimetres unless noted otherwise. All levels in metres unless noted otherwise.
 4. Any discrepancies noted on site are to be reported to the engineer immediately.
 5. ANPR locations shown indicatively. Subject to detailed design, survey and approval by relevant highway authorities.

Legend

— LCC Highway Boundary

P01	20.02.24	Preliminary Issue	SC	AP
Rev	Date	Details of issue / revision	Drw	Rev

Issues & Revisions

BWB
A CAF GROUP COMPANY

- Birmingham | 0121 233 3322
- Leeds | 0113 233 8000
- London | 020 7407 3879
- Manchester | 0161 233 4260
- Nottingham | 0115 924 1100

www.bwbconsulting.com

TRITAX SYMMETRY
A TRITAX BIG BOX COMPANY

Project Title
**HINCKLEY NATIONAL RAIL
FREIGHT INTERCHANGE**

Drawing Title
**HGV ROUTING
STRATEGY
ANPR CAMERA 9
LOCATION**

Drawn:	S. Carter	Reviewed:	A. Passmore
BWB Ref:	NTT2814	Date:	20.02.24
Scale@A1:	As Shown		

PRELIMINARY

Project - Originator - Zone - Level - Type - Role - Number	Status	Rev
HRF-BWB-HSN-09-DR-CH-1250	S2	P01

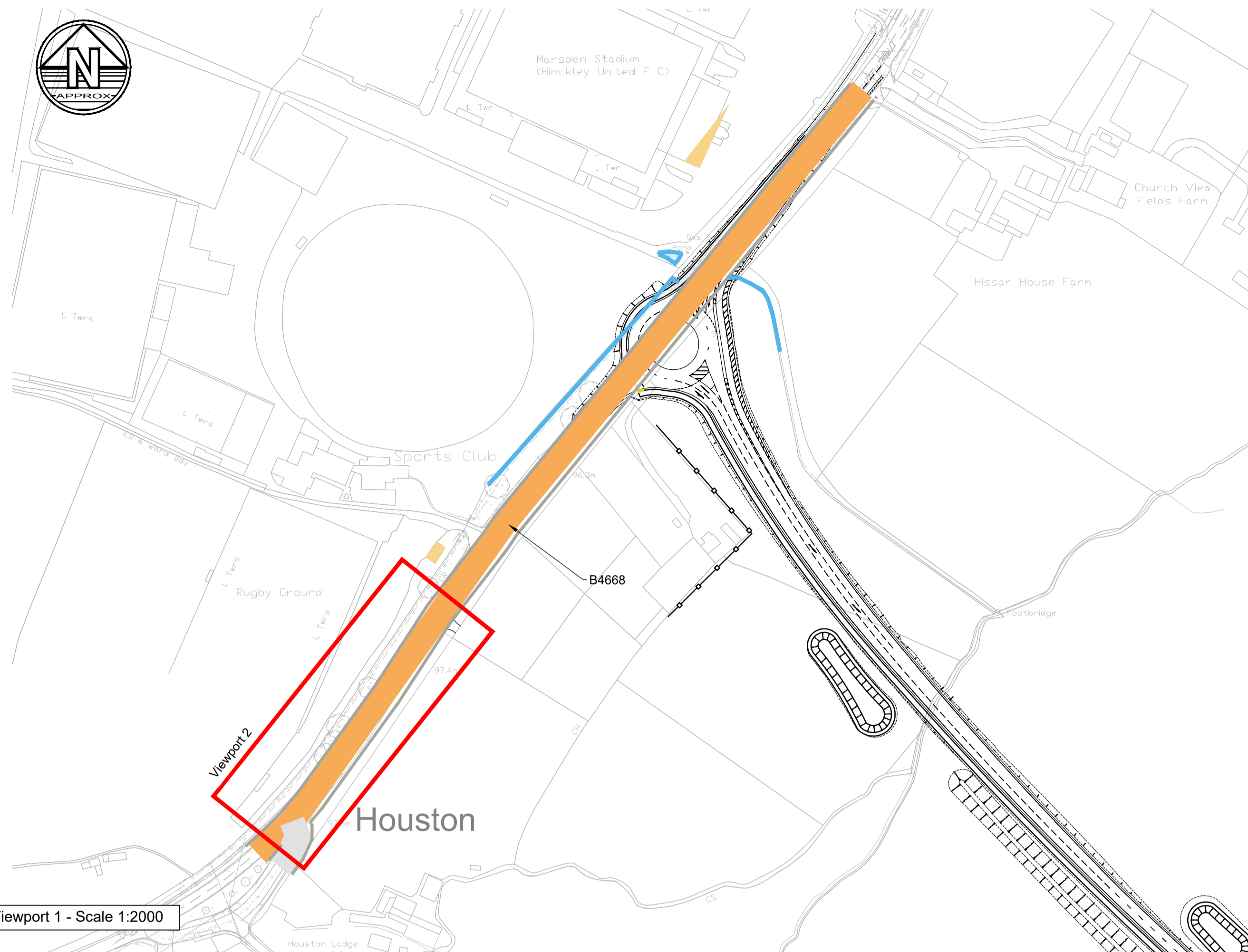

Streetview Image of Approximate Location

Notes

1. Do not scale this drawing. All dimensions must be checked/ verified on site. If in doubt ask.
2. This drawing is to be read in conjunction with all relevant architects, engineers and specialists drawings and specifications.
3. All dimensions in millimetres unless noted otherwise. All levels in metres unless noted otherwise.
4. Any discrepancies noted on site are to be reported to the engineer immediately.
5. ANPR locations shown indicatively. Subject to detailed design, survey and approval by relevant highway authorities.

Legend

— LCC Highway Boundary

P01	20.02.24	Preliminary Issue	SC	AP
Rev	Date	Details of issue / revision	Drw	Rev

Issues & Revisions

BWB
A CAF GROUP COMPANY

- Birmingham | 0121 233 3322
- Leeds | 0113 233 8000
- London | 020 7407 3879
- Manchester | 0161 233 4260
- Nottingham | 0115 924 1100

www.bwbconsulting.com

Client

TRITAX SYMMETRY
A TRITAX BIG BOX COMPANY

Project Title

HINCKLEY NATIONAL RAIL FREIGHT INTERCHANGE

Drawing Title

HGV ROUTING STRATEGY ANPR CAMERA 10 LOCATION

Drawn:	S. Carter	Reviewed:	A. Passmore
--------	-----------	-----------	-------------

BWB Ref:	NTT2814	Date:	20.02.24	Scale@A1:	As Shown
----------	---------	-------	----------	-----------	----------

Drawing Status

PRELIMINARY

Project - Originator - Zone - Level - Type - Role - Number	Status	Rev
HRF-BWB-HSN-10-DR-CH-1250	S2	P01

Viewport 1 - Scale 1:2000

Viewport 2 - Scale 1:200

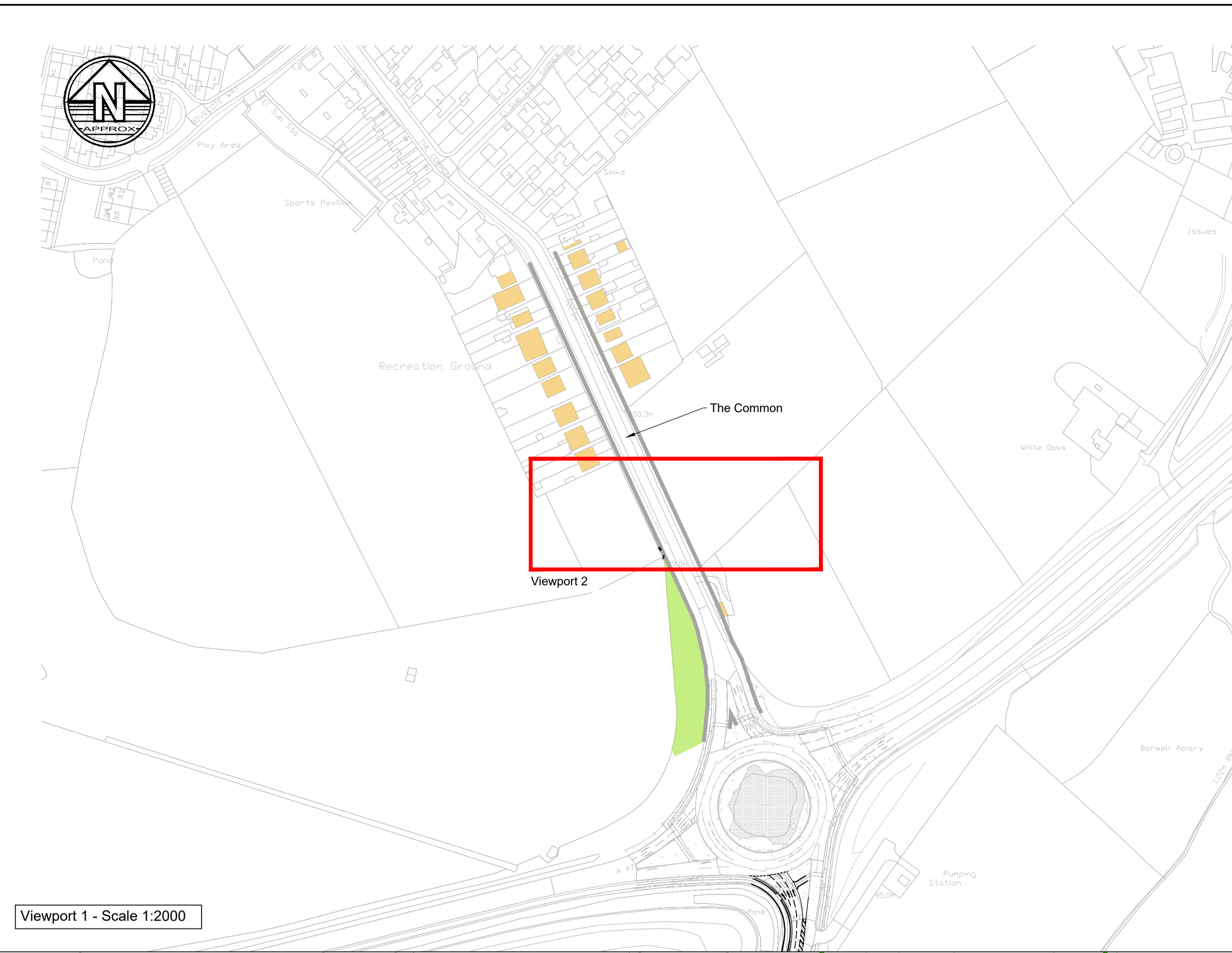

Viewport 1 - Scale 1:2000



Streetview Image of Approximate Location

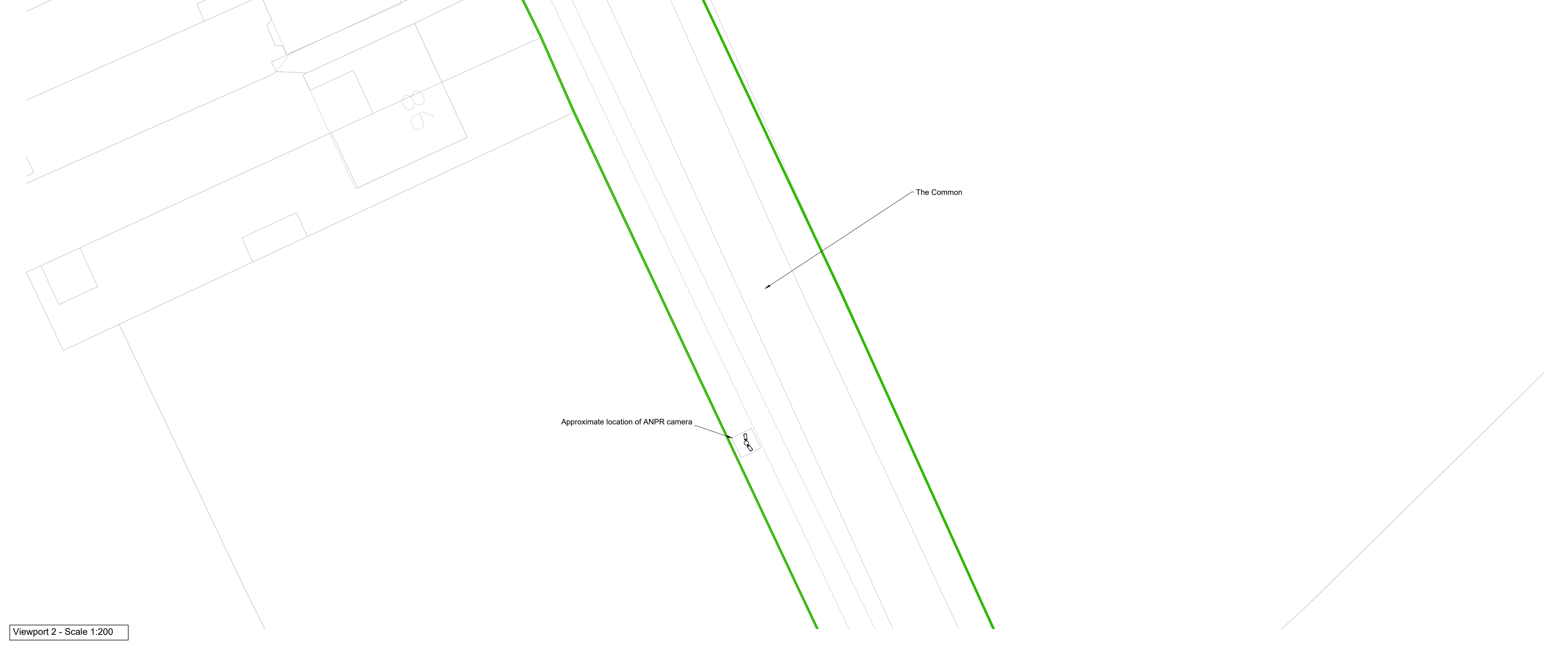

Viewport 2 - Scale 1:200

- Notes**
1. Do not scale this drawing. All dimensions must be checked/ verified on site. If in doubt ask.
 2. This drawing is to be read in conjunction with all relevant architects, engineers and specialists drawings and specifications.
 3. All dimensions in millimetres unless noted otherwise. All levels in metres unless noted otherwise.
 4. Any discrepancies noted on site are to be reported to the engineer immediately.
 5. ANPR locations shown indicatively. Subject to detailed design, survey and approval by relevant highway authorities.

Legend

— LCC Highway Boundary

P01	20.02.24	Preliminary Issue	SC	AP
Rev	Date	Details of issue / revision	Drw	Rev

Issues & Revisions

BWB
A CAF GROUP COMPANY

- Birmingham | 0121 233 3322
- Leeds | 0113 233 8000
- London | 020 7407 3879
- Manchester | 0161 233 4260
- Nottingham | 0115 924 1100

www.bwbconsulting.com

Client

TRITAX SYMMETRY
A TRITAX BIG BOX COMPANY

Project Title

HINCKLEY NATIONAL RAIL FREIGHT INTERCHANGE

Drawing Title

HGV ROUTING STRATEGY ANPR CAMERA 11 LOCATION

Drawn:	S. Carter	Reviewed:	A. Passmore
BWB Ref:	NTT2814	Date:	20.02.24
Scale@A1:	As Shown		

Drawing Status

PRELIMINARY

Project - Originator - Zone - Level - Type - Role - Number	Status	Rev
HRF-BWB-HSN-11-DR-CH-1250	S2	P01